

Ceramic Transducer Design Co.,Ltd

TEL: +886-3-3614555 FAX +886-3-3674408 E-mail: sale@ctdco.com.tw

Photo:



Standard type of this sensor:

40T/R-16F	Flower case with aluminum case
40T/R-16W	White mesh with aluminum case
40T/R-16B	Black mesh with aluminum case
40T/R-16P	Plastic black case

Specification:

PARTS NUNBER	40T-16	40R-16
Center frequency (kHz)	40.0±1.0kHz	40.0±1.0kHz
Sound pressure level (0dB=0.0002 μ bar)	≥ 119dB	-----
Sensitivity (0dB vs 1V/ μ bar)	-----	≥ -65dB
Bandwidth (kHz)	4.0/112dB	3.5/-71dB
Beam angle -6dB	55°	
Driving voltage (RMS)	30V	
Working temperature (°C)	-30~80	

Dimension(40T/R-16F):

A=16.1±0.3

B=12.0±0.4

C= 9.5±1.0

D=10.0±0.5

E=1.0±0.1

(UNIT: mm)

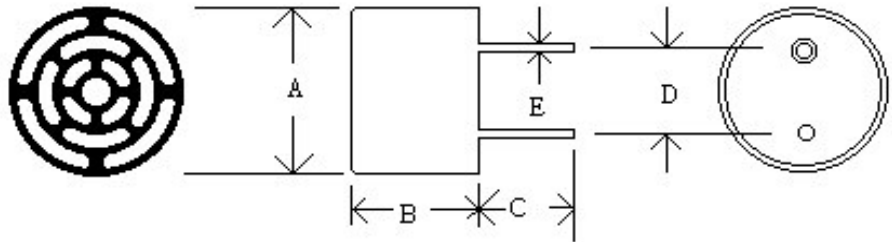

Sound pressure level

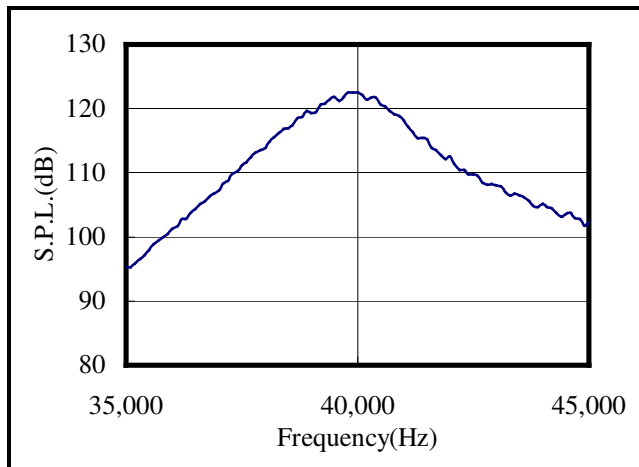

Sensitivity

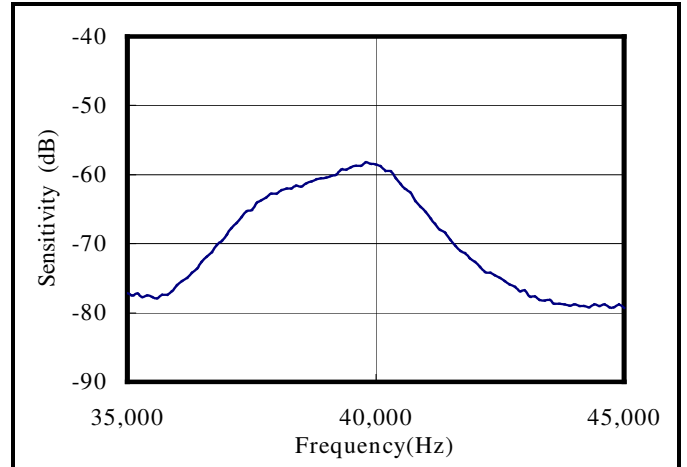

Transmitter impedance

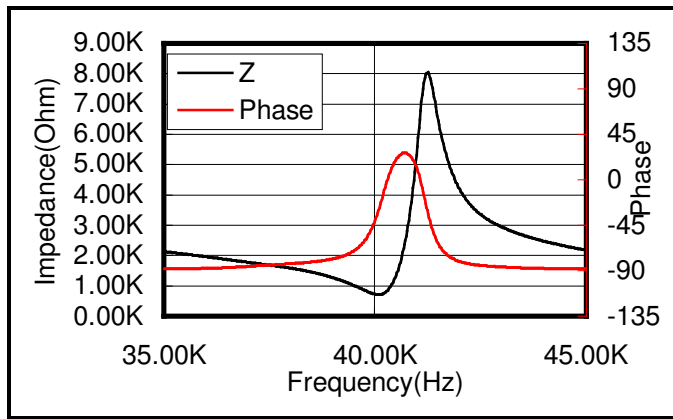

Receiver impedance

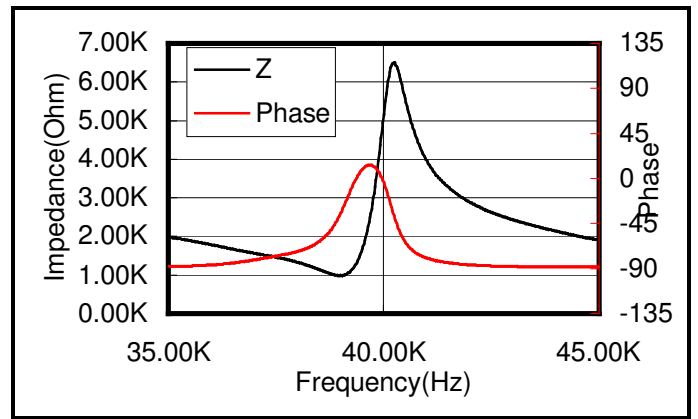

Beam angle of transmitter

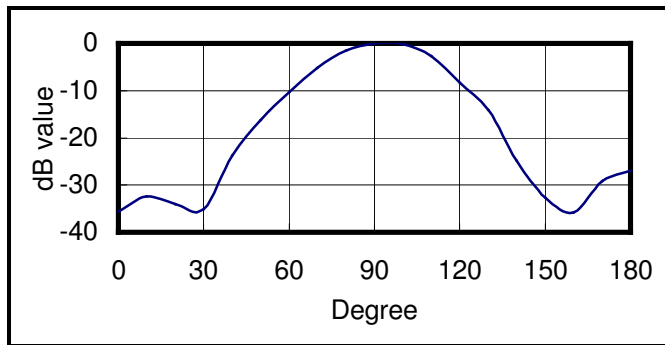

Beam angle of receiver

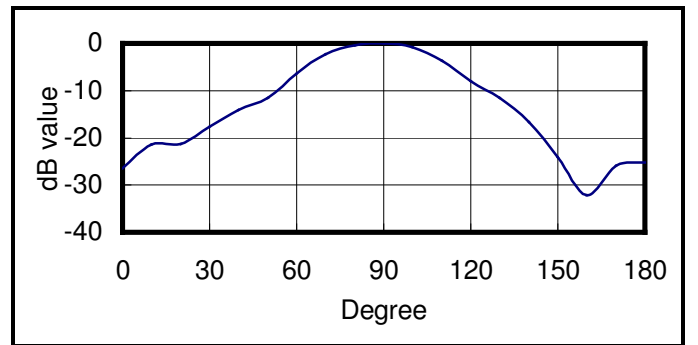

Environment test

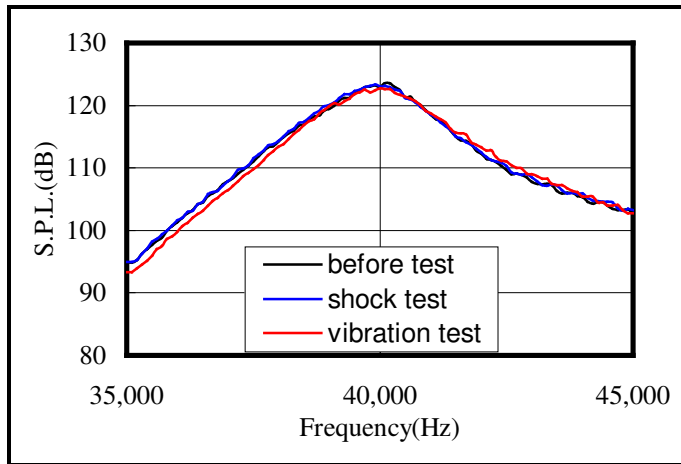

Temperature test

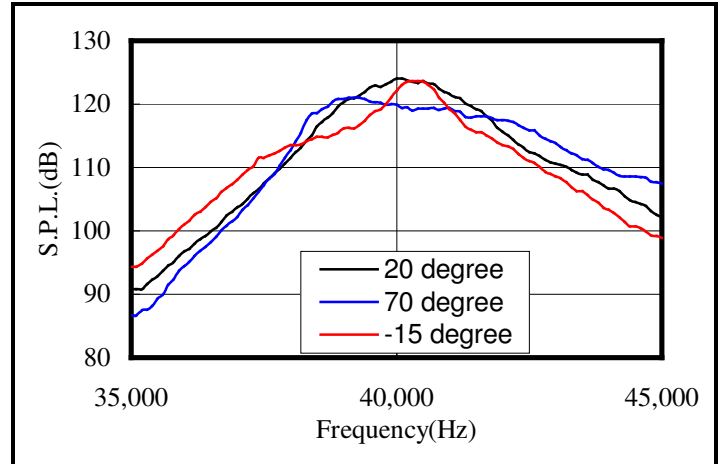

Sensitivity change with load resistance

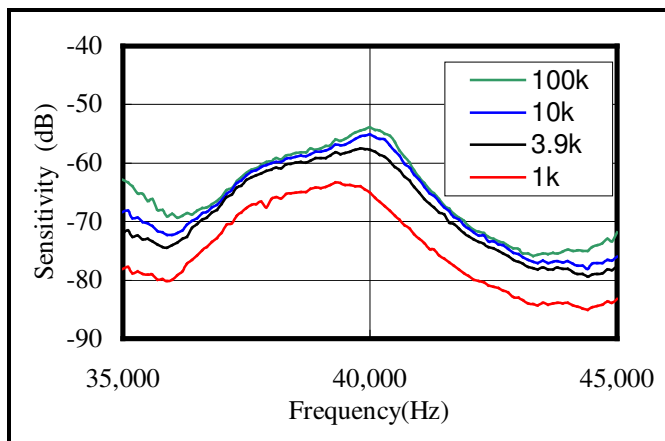

S.P.L. change with driving voltage

